

Environmental Class® Sound Retardant Doors

Marshfield Signature Series®

Positive Pressure with Frame Mounted Intumescents - 20-MINUTE and 45-MINUTE
(EDSRUF45-PPFM, EDSRUF46-PPFM, EDSRUF47-PPFM)(30)



Urea Formaldehyde Free

Product Features and Specifications

Interior Only (1)

Thickness	1-3/4"
Acoustic Rating	STC-45, STC-46, STC-47: per ASTM E90-90 and E413
Maximum Size	WH-ITS & UL: 4/0 x 8/0 (45)
Minimum Size	1/5-3/4 x 5/11-1/4
Faces	• Wood Veneer • Primed MDO • Decorative Laminate
Crossbands	Urea Formaldehyde Free Engineered Fiber
Stiles	Tectonite on the lock stile and AT Soft Maple Natural on the hinge stile with veneer bands or decorative laminate to match face.
Top and Bottom Rails	Tectonite
Face Assembly Adhesive	Type II (water resistant)
Core Assembly Adhesive	Not applicable
Core	Acoustic Pan
Lite Openings	Not available
Other Detail Work (7,21,41,42,47,48)	• Fitting • Machining
Factory Finish (8)	• Clear or Stain w/ Enviroclad UV® finish • Prime • Opaque with flat gloss topcoat
Warranty	Full; 1 year warranty (1)
Door Weight	9.3 lbs. per sq. ft.
Required Hinges (61)	Doors up to and including 90" require 3 hinges; doors over 90" require 4 hinges (per NFPA 80). 0.190" x 5" x 4-1/2" hinges are recommended, however, 0.180" x 4-1/2" x 4-1/2" may be used.

*Refer to separate page for explanation of footnotes.

The Marshfield DoorSystems, Inc. EDSRUF45 and EDSRUF46 must be installed one of two ways to achieve an operable STC rating of 45 or 46:

- With two (2) rows of Marshfield DoorSystems, Inc. supplied gasketing on the head and jambs of the frame and a bottom drop seal supplied by Marshfield DoorSystems, Inc.
- With two (2) rows of Marshfield DoorSystems, Inc. supplied gasketing on the head and jambs of the frame and a gasketed ADA approved threshold on the bottom.

The Marshfield DoorSystems, Inc. EDSRUF47 must be installed with two (2) rows of marshfield DoorSystems, Inc. supplied gasketing on the head and jambs of the frame and a bottom drop seal supplied by Marshfield DoorSystems, Inc. to achieve an operable STC rating of 47.

Automatic Door Bottom Detail
Doors are machined at the factory for jobsite installation of bottom seal. Bottom seal must seal to a flat, solid surfaced floor. No threshold is required.

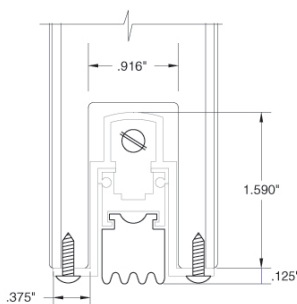

Zero 360 Automatic Bottom Seal

Note: Marshfield DoorSystems, Inc. doors are manufactured per the standards listed on this page. Specifications are subject to change without notice.

DOOR GASKETING

STC Stop Detail
The perimeter gaskets can be easily installed in combination with any metal or wood frame. The gasket does not reduce the frame opening size. Apply the two S88 Pemko door gaskets around the sides and top of the frame.
For positive pressure fire applications a strip of Pemko HS2000 is applied beneath the jamb applied gasketing.

